

DISTRIBUTED BY 

 **KRONOTEX**

BY SWISS KRONO GROUP

FLOORS FOR LIVING **2018**

Made in 
Germany 



BY SWISS KRONO GROUP

DISTRIBUTED BY 

Beautiful, durable and affordable. Kronotex combines the ingenuity of German engineering with the beauty of timber to deliver stunning, hard-wearing laminates that mirror the splendour of solid wood floors.

Designed and manufactured in Germany, Kronotex's cutting edge surface structures (see page 22) collide with authentic timber patterns to create strikingly realistic woodgrains. The breadth of these woodgrains and colours available across the MAMMUT, MAMMUT PLUS, EXQUISIT PLUS, EXQUISIT and DYNAMIC ranges intertwine the traditional with the latest European trends. This results in designs that are both timeless and alive with personality. From deep, dark and elegant to light and weathered.

From extra long planks to extra wide. There is a Kronotex design to elevate your interior style.

The enviable quality of German manufacturing means Kronotex Laminates are so robust they can be installed in both commercial and residential settings – making them perfect for busy Australian homes.

With Kronotex Laminate there is no limit to where your imagination can carry you!



D4787 Gala Oak White | EXQUISIT PLUS



MAMMUT

kronotex.com

D 4752 Makro Oak Light



MAMMUT

kronotex.com

D 4752 Makro Oak Light

MAMMUT

Luxury is the motto of MAMMUT. Boasting 12mm thick boards, MAMMUT feels and sounds so solid underfoot it is indistinguishable from hardwood floors. The authenticity of the range is amplified further by its impressive wood grains and warming colours. The registered emboss (see page 22) and matt finish is so captivatingly realistic it encourages tactile exploration. This luxuriousness is further enhanced by the range's extra-long planks which, combined with its micro-bevel edges, creates spaces characterized by elongated elegance. Boasting an AC5 abrasion rating and a Use Class of 33, MAMMUT is so sturdy it will maintain its beauty even in heavy-traffic commercial spaces.*

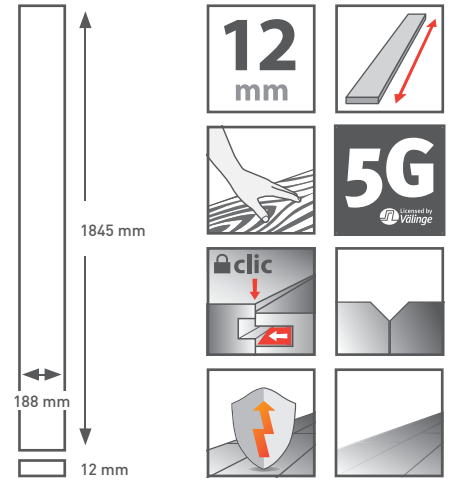

USE CLASS 33 | AC5

BOX 4 panels | 1.387m²

PALLET 56 boxes | 77.697m²





MAMMUT PLUS

Dramatic dimensions define MAMMUT PLUS, an exciting and premium range of laminate flooring featuring planks that are both extra wide and extra-long. The width and length of MAMMUT PLUS planks create calming atmospheres that exude spaciousness. The impressive dimensions combined with the micro-bevel edge and authentic wood grains encourage the gaze to wander, while the registered emboss is so seductively realistic it encourages bare-foot exploration. Boasting an AC5 abrasion rating and a Use Class of 33, MAMMUT PLUS is so sturdy it will maintain its beauty even in heavy-traffic commercial spaces.*

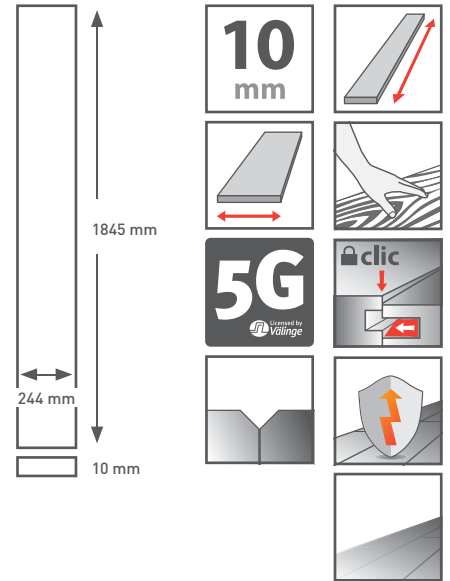

USE CLASS 33 | AC5

BOX 4 panels | 1.800m²

PALLET 42 boxes | 75.600m²





EXQUISIT PLUS

kronotex.com **D 4767** Palace Oak Dark





EXQUISIT PLUS

Featuring extra-wide panels, EXQUISIT PLUS invites you to create spacious rooms with a warm ambiance. The collection's decors feature a small range of carefully selected, natural wood styles. Their embossed, subtly gleaming surfaces and realistic grain characterize the exceptional quality of EXQUISIT PLUS. The micro bevel edge is the finishing touch to this attractive plank floor. Boasting an AC4 abrasion rating and a Use Class of 32, EXQUISIT PLUS is robust enough for both residential and average commercial use.*

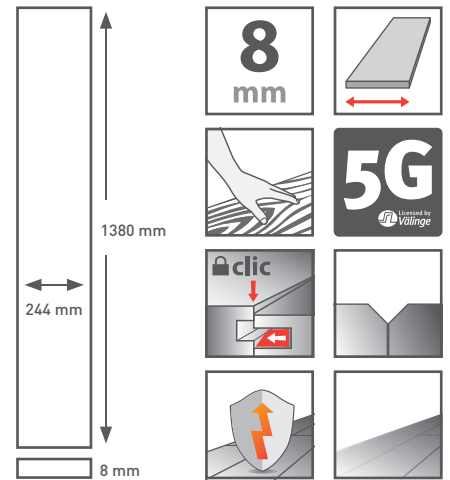

USE CLASS 32 | AC4

BOX 8 panels | 2.694 m²

PALLET 42 boxes | 113.138 m²

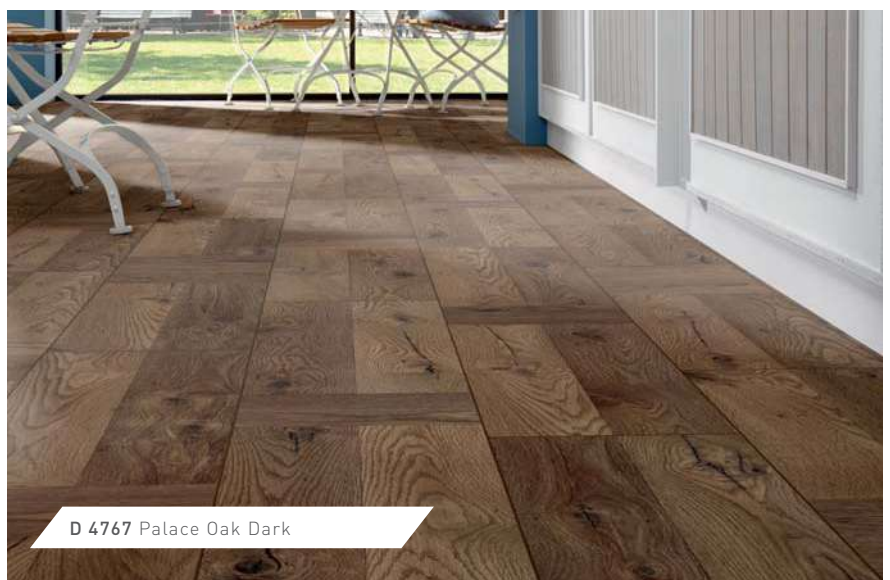
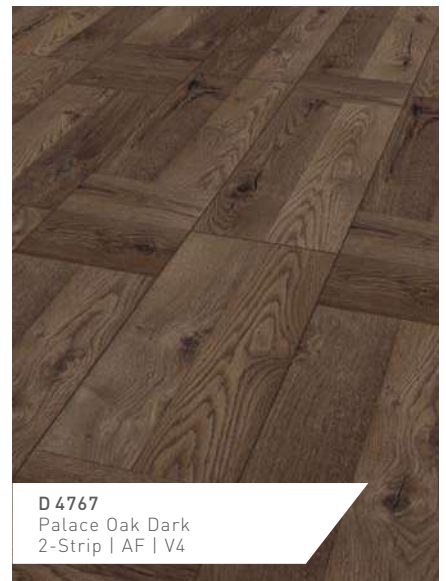
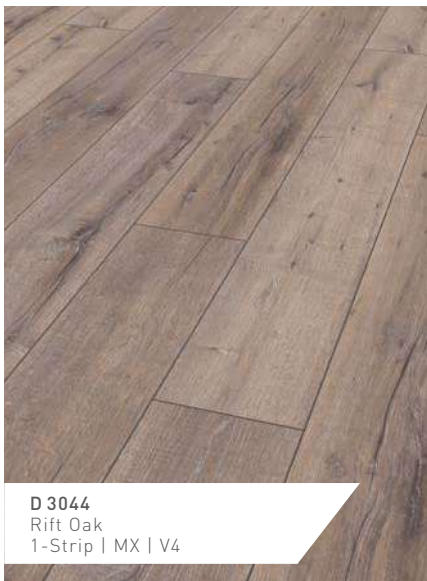



EXQUISIT

kronotex.com

D 4754 Oak Hella



EXQUISIT

Embossed with an authentic grain structure, EXQUISIT embraces the beauty of timber. This synchronised, embossed grain and matt surface shimmer create authenticity to fill your space with a warm, natural atmosphere. Featuring 12 colours, and a range of special surface structures including used look (see page 22), EXQUISIT has both contemporary and classic decors to suit all spaces. Boasting an AC4 abrasion rating and a Use Class of 32, EXQUISIT is robust enough for both residential and average commercial use.*

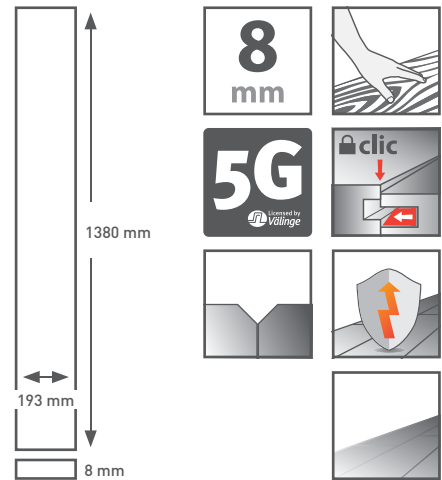

USE CLASS 32 | AC4

BOX 8 panels | 2.131m²

PALLET 56 boxes | 119.320m²

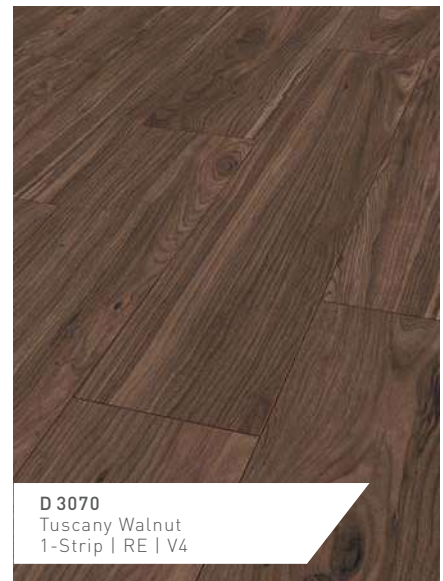



D 4754 Oak Hella



D 4754
Oak Hella
1-Strip | UL | V4



D 4760
Alto
1-Strip | AF | V4



D 4763
Petterson Oak Beige
1-Strip | RE | V4



D 4765
Petterson Oak Grey
1-Strip | RE | V4



D 4786
Gala Oak Grey
1-Strip | RE | V4



D 4171
Nostalgie Teak Graphit
1-Strip | RE | V4



DYNAMIC

kronotex.com

D 4155 Luxury Oak Silver

DYNAMIC

Lively and evocative, DYNAMIC features a unique variety of patterns and hues. The six curated decors are so fresh and stylish, they'll inspire you and elevate your interior style. Featuring square edges for a sleek and seamless finish, DYNAMIC is also easy to maintain. Its versatility and strength make DYNAMIC the ideal all-rounder, suitable for both homes and commercial settings. Boasting an AC4 abrasion rating and a Use Class of 32, DYNAMIC is robust enough for both residential and average commercial use.*

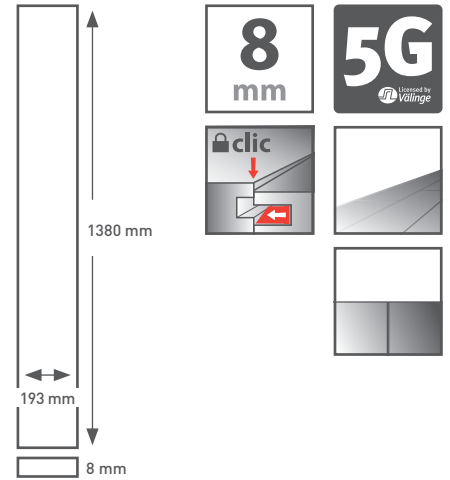

USE CLASS 32 | AC4

BOX 8 panels | 2.131 m²

PALLET 56 boxes | 119.320 m²



SURFACES



1-Strip

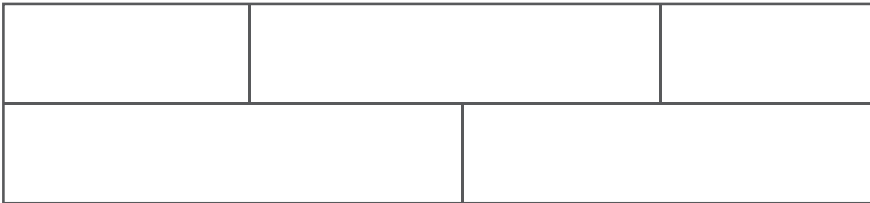

2-Strip

CHARACTERISTICS



Kronotex floors are low-maintenance and hard-wearing.



Kronotex floors are flame resistant.



Kronotex floors are abrasion and scratch resistant.



Kronotex floors are non-fading and retain their brilliance over many years.



Kronotex floors are rugged, load and impact-resistant.



Kronotex floors are stain-resistant.



Kronotex floors are produced from natural sustainable raw materials.



Kronotex floors are comfortable underfoot.

INDIVIDUAL FEATURES

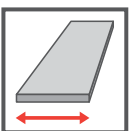

These panels are especially wide.

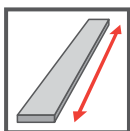

These panels are especially long.



These panels have a special surface structure.



Antistatic



A 5G snap-together system makes the flooring even easier to install.



Simple to lay. Safe and stable, you can walk on them right away.



A matt finish to replicate the appearance of timber.



Square edges create a seamless finish.

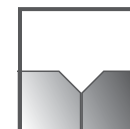

Micro bevel edges produce a natural solid wood character.

*Excludes: Areas prone to getting wet such as bathrooms, toilets and laundries.

KRONOTEX PRODUCT OVERVIEW

MAMMUT

PANEL 1845 x 188 x 12 mm

BOX 4 panels | 1.387 m²

PALLET 56 boxes | 77.697 m²

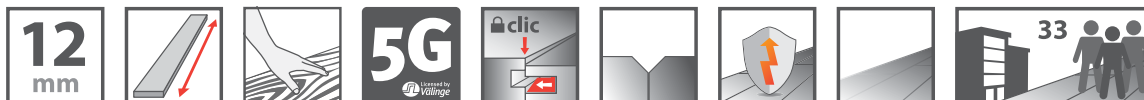

AC 5
COMMERCIAL 33

MAMMUT PLUS

PANEL 1845 x 244 x 10 mm

BOX 4 panels | 1.800 m²

PALLET 42 boxes | 75.600 m²



AC 5
COMMERCIAL 33

EXQUISIT PLUS

PANEL 1380 x 244 x 8 mm

BOX 8 panels | 2.694 m²

PALLET 42 boxes | 113.138 m²

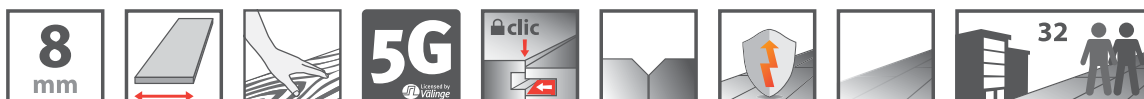

AC 4
COMMERCIAL 32

EXQUISIT

PANEL 1380 x 193 x 8 mm

BOX 8 panels | 2.131 m²

PALLET 56 boxes | 119.320 m²



AC 4
COMMERCIAL 32

DYNAMIC

PANEL 1380 x 193 x 8 mm

BOX 8 panels | 2.131 m²

PALLET 56 boxes | 119.320 m²



AC 4
COMMERCIAL 32

STRUCTURES

MX / Matrix

An advanced technique which uses the contrast between matt and gloss finishes to create depth and mimic the deep grooves of wood grains.

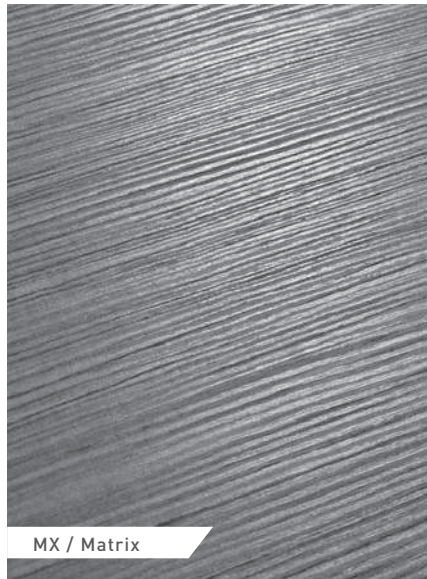

MX / Matrix

RE / Registered Emboss

A textured surface layer matches perfectly with the pattern of the grain beneath it to create a beautifully realistic surface that is difficult to distinguish from hard-wood floors.



RE / Registered Emboss

CP/Chrome Pore

A shine effect is added to the grain pattern to play with light and add depth to the floor's finish.



Shine Effect

CP/Chrome Pore



AF / Authentic Floor

AF / Authentic Floor

A highly detailed finish that results in a vivid and natural wood texture.

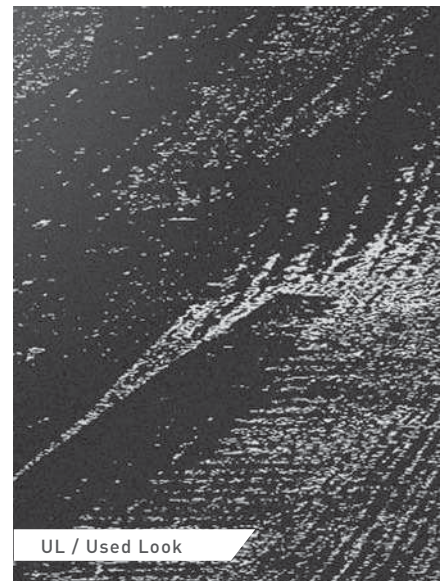

UL / Used Look

UL / Used Look

A decorative finish that mimics the weathered look of well-loved hard-wood floors to create a beautifully realistic used look.

PANEL CONSTRUCTION

Kronotex laminates consist of a minimum of four stable layers which ensure the extraordinary durability and unique quality of Kronotex floors.



- A** The top surface of the flooring consists of a specially resistant protective overlay film. This is fused with an attractive resinated decorative film into a practically abrasion-proof, hardwearing surface.
- B** Extremely dense HDF fiberboard forms the supportive core (HDF, E1).
- C** On the undersurface of the core, a dampness impeding stabilization film ensures and preserves the high structural stability of Kronotex laminates.

THE CLIC-SYSTEM

Installing a floor becomes child's play: Simply unpack, lay, snap together and done. No effort involved – your hammer and block can stay in the tool box.



Long side

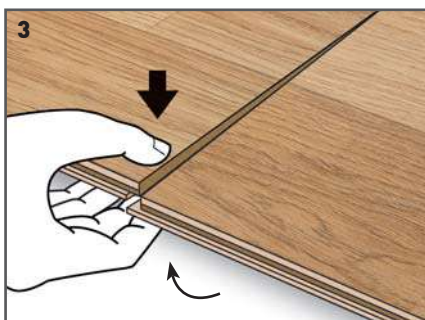

Short side

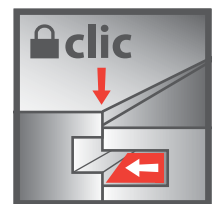
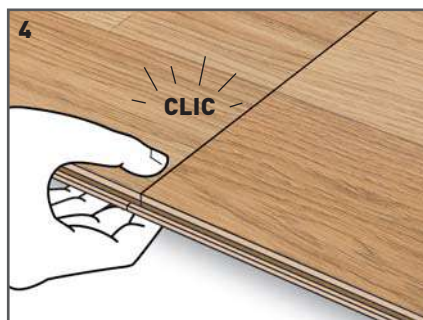

- Much easier to install.
- Up to 50% quicker to install.
- No hammer, tapping block and pulling bar required.
- Safe and stable.
- You can walk on the floor immediately after installation.

Art.-Nr.: T00002

Layout: Vogelsänger

Pictures: SWISS KRONO TEX, Vogelsänger, Shutterstock, Döring & Waesch
EN 002-0218-DW-WEI



— *The Force in Flooring* —

Australian Flooring Supplies
68 Prosperity Way, Dandenong South
VIC 3175

1300 737 155

afscustomerservice@qep.com